

TRESU UniPrint Chamber Doctor Blade System

Quick Clamping System
Pneumatic
Excentric

P-Line



E-Line

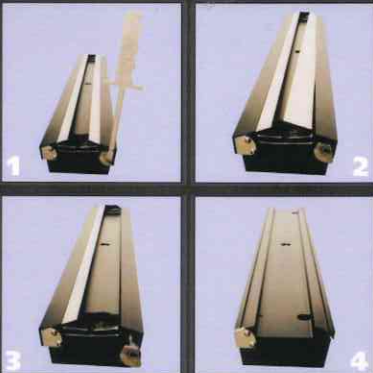

- **Universal chamber construction, customized for any application and printing press**
- **From 80 to 6000 mm**
- **For up to 1000 m/min production speed**
- **Different doctor blade clamping systems**
S-Line: Screw system, used e.g. for special coating
E-Line: For chambers up to 2000 mm
P-Line: For aqueous inks and coatings only
- **For special special applications such as:**
Pressure controlled ink/coating circulation with manual or closed loop control system, multiple in- and outlets
- **Different construction principles, depending on space condition and/or applications**

Technical Specifications

Inks/Coatings:	All
Speed:	Up to 1000 m/min
Circulation:	Closed, open, pressure controlled
Construction:	Always customized
Anilox Ø:	From 80 to 400
Anilox width:	Up to 6000 mm
Ink:	Water based only

- the printer's choice -